

3.96 Pitch 3060 SERIES CONNECTOR



3.96 mm Pitch Wire-to-Board Connector



Specifications

- ◇ Current rating: 7A AC/DC Max.
- ◇ Voltage Range: 250V AC,DC
- ◇ Withstand Voltage: 1500V AC/Minute
- ◇ Contact Resistance: 10 mΩ Max. before environment test
- ◇ Insulation Resistance: 1000 MΩ Min.
- ◇ Temperature Range: -40° C to 105° C

Reference

- ◇ Mates with 3060S series Plug Housing
- ◇ Mates with 3360R IDC series Plug Housing

3061P, 3062P DIP Header

(Type E, Type E-1)

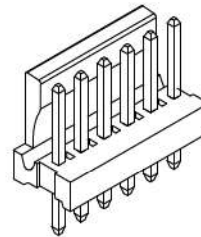

3061P Type-E

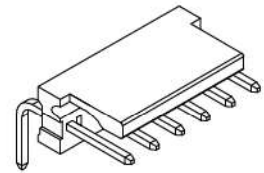

3062P Type-E

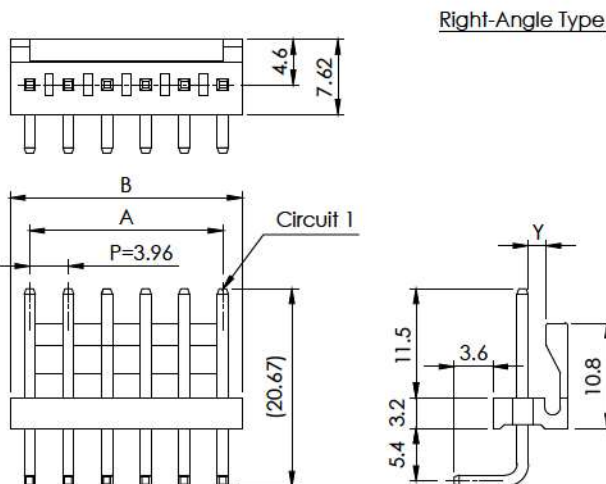
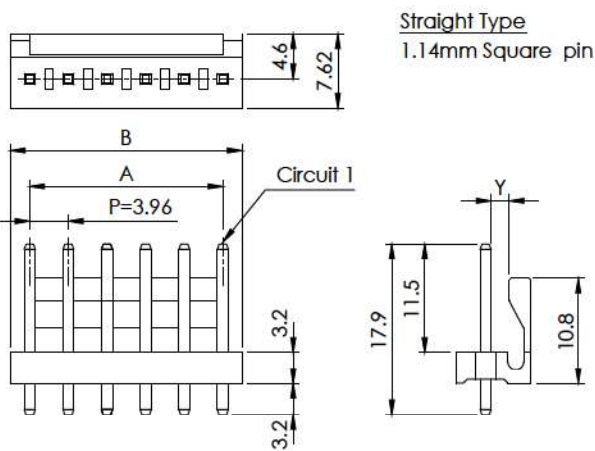

Ordering Information

Circuits	Part No. (Type-E, Y=1.5)		Dimension		
	Straight	Right-Angle	A	B	Y
2	3061P02E3T	3062P02E3T	3.96	7.92	1.5
3	3061P03E3T	3062P03E3T	7.92	11.88	1.5
4	3061P04E3T	3062P04E3T	11.88	15.84	1.5
5	3061P05E3T	3062P05E3T	15.84	19.80	1.5
6	3061P06E3T	3062P06E3T	19.80	23.76	1.5
7	3061P07E3T	3062P07E3T	23.76	27.72	1.5
8	3061P08E3T	3062P08E3T	27.72	31.68	1.5

Circuits	Part No. (Type E-1, Y=1.85)		Dimension		
	Straight	Right-Angle	A	B	Y
8	3061P08E3T-S1	3062P08E3T-S1	27.72	31.68	1.85
9	3061P09E3T-S1	3062P09E3T-S1	31.68	35.64	1.85
10	3061P10E3T-S1	3062P10E3T-S1	35.64	39.60	1.85
11	3061P11E3T-S1	3062P11E3T-S1	39.60	43.56	1.85
12	3061P12E3T-S1	3062P12E3T-S1	43.56	47.52	1.85
13	3061P13E3T-S1	3062P13E3T-S1	47.52	51.48	1.85
14	3061P14E3T-S1	3062P14E3T-S1	51.48	55.44	1.85
15	3061P15E3T-S1	3062P15E3T-S1	55.44	59.40	1.85

Material

Part	Material / Finish
Base	Glass-filled PBT 94V-0, white (natural color)
Contact	Brass, Tin-Plated

※ PART NUMBER ASSIGNMENT:

ex. 3061P XX E X* X (white /natural color)

ex. 3062P XX E X* X - S1 (white /natural color)

XX... Circuit Nos (PIN Numbers)

X... Plating Selection: T... Tin, V... Matte Tin

X*... Plastics Material no.: 3... PBT-GF 94V-0,

Color no.: S... White, R... Red, B... Black color

P.C. Board Layout / Assembly Layout

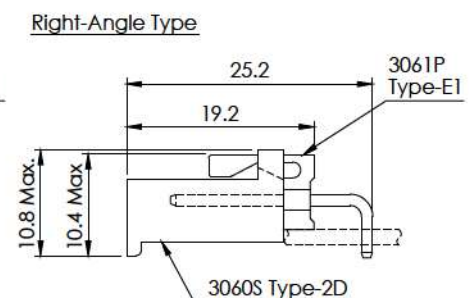
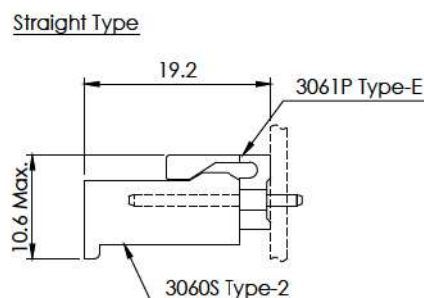
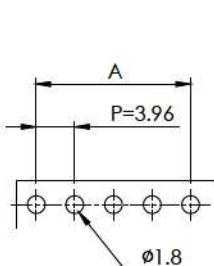

3.96 Pitch 3360 SERIES CONNECTOR



3.96 mm Pitch Wire-to-Board Connector



Specifications

- ◇ Current rating: 7A AC/DC Max.
- ◇ Voltage Range: 250V AC,DC
- ◇ Withstand Voltage: 1500V AC/Minute
- ◇ Contact Resistance: 7 mΩ Max. before environment test
- ◇ Insulation Resistance: 1000 MΩ Min.
- ◇ Temperature Range: -25° C to 90° C

Reference

- ◇ Mates with 3061P, 3062P Type-E and Type-E1 series PCB Header

3360R IDC Plug Housing

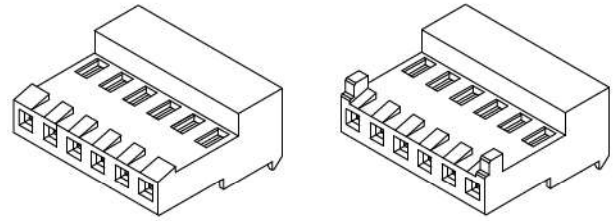

3360R Type-1

3360R Type-2

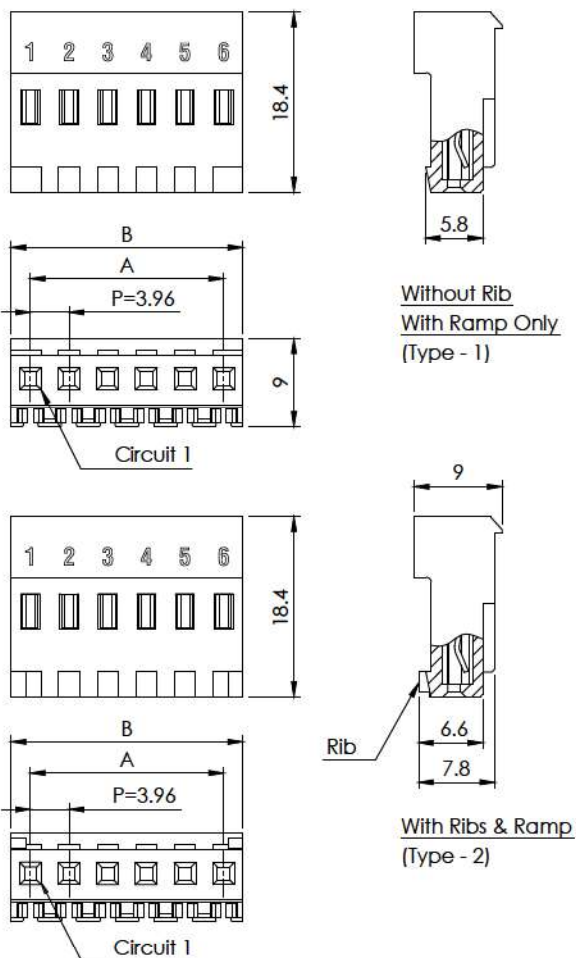

Ordering Information

Circuits	Part No.		Dimension	
	Without Ribs	With Ribs	A	B
2	3360R0212T-X	3360R0222T-X	3.96	7.92
3	3360R0312T-X	3360R0322T-X	7.92	11.88
4	3360R0412T-X	3360R0422T-X	11.88	15.84
5	3360R0512T-X	3360R0522T-X	15.84	19.80
6	3360R0612T-X	3360R0622T-X	19.80	23.76
7	3360R0712T-X	3360R0722T-X	23.76	27.72
8	3360R0812T-X	3360R0822T-X	27.72	31.68
9	3360R0912T-X	3360R0922T-X	31.68	35.64
10	3360R1012T-X	3360R1022T-X	35.64	39.60
11	3360R1112T-X	3360R1122T-X	39.60	43.56
12	3360R1212T-X	3360R1222T-X	43.56	47.52
13	3360R1312T-X	3360R1322T-X	47.52	51.48
14	3360R1412T-X	3360R1422T-X	51.48	55.44

Material

Part	Material	Applicable Wire Gauge	Color Coding = X
IDC Plug	Nylon 66 94V-2	26 AWG	X = E - Blue
		24 AWG	X = S - Natural
		22 AWG	X = R - Red
		20 AWG	X = Y - Yellow
		18 AWG	X = D - Orange

Assembly Layout

Straight Type

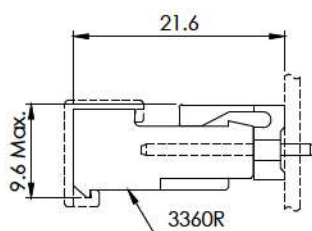

Right-Angle Type

