



慈溪市万捷电子有限公司

CIXI WANJIE ELECTRONIC CO., LTD

产品规格书

product specification

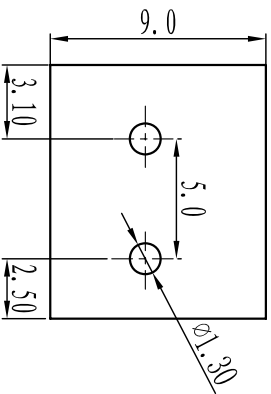
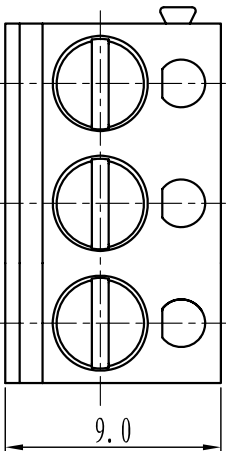
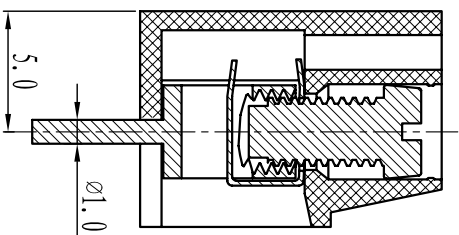
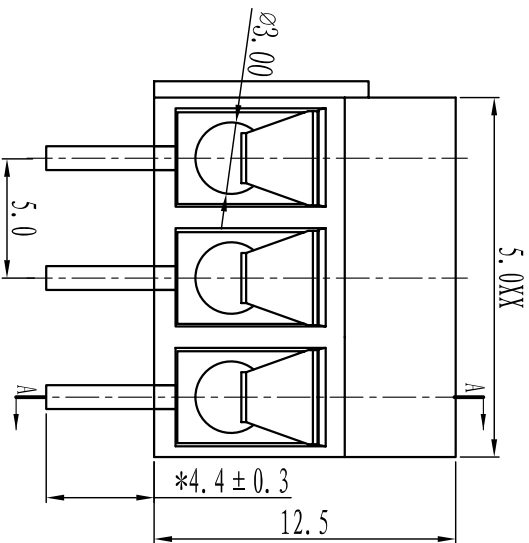

SECTION A-A

电气性能/Electrical

参考标准/Standard: UL IEC
 额定电压/Rated voltage: 250V 250V
 额定电流/Rated current: 16A 24A
 接触电阻/Contact resistance: 20mΩ
 使用线径/Wire range: 22-14AWG 2.5mm²
 耐电压/Withstanding voltage: AC2000V/1Min
 绝缘电阻/Insulation resistance: 500MΩ/DC500V

机械性能/Mechanical

温度范围/Temp.Range: -30°C~+120°C
 扭矩/Torque: 0.5Nm(4.5lb·in)
 剥线长度/Strip length: 4.5-5mm

尺寸/Dimensions

间距/Pitch: 5.00mm
 极数/Poles: 2P-24P

材质及电镀/Material

塑件/Housing: PBT, UL94V-0
 螺丝/Screws: M3.0, steel Zinc plated
 方针/Pin header: Brass, Ni plated
 弹片/Strapnel: Phosphor bronze, Ni plated

TOLERANCES EXCEPT AS NOTED

	linear dimension	fillet	chamfer	short angle sid	≡	□	//	⊥
variable range	over 6 to 30 over 30 to 120 over 120 to 480	all	over 6 to 10	over 10 to 50 over 50 to 120	all	over 5 to 30 over 30 to 120	over 120 to 120	
tolerance	±0.1 to 30 ±0.2 to 120 ±0.3 to 480	±0.2	±0.5 to 6 ±1 to 10	30' to 10'	0.5 to 5	0.025 to 0.06	0.12 to 0.4	

订购方式 : HOW TO ORDER

- - P - - -

1. 未定义/No definition
 2. 单间距/Single pitch
 3. 双间距/Double pitch

客户需求 Customer Request

灰色/Gray	10	绿色/Green	40	透明/Transparent	70
蓝色/Blue	20	棕色/Orange	50	黄色/Yellow	80
黑色/Black	30	红色/Red	60	白色/White	90

单位/UNITS mm 尺寸/SIZE A4 比例/SCALE 比例



第一视角/FIRST ANGLE PROJECTION



慈溪市万捷电子有限公司
 CIXI WANJIE ELECTRONIC CO., LTD

名称/NAME

WJ300-XXP-1YV-00A